

QL-31A load cells are available in the capacities from 1 kg to 500 kg S beam style. Tension and/or compression loading.

Alloy steel or stainless steel, Silicon adhesive sealed inside, waterproof, anti-corrosion and suitable for all kinds of environment.

Integral structure and easy installation.

Suitable for crane scale, mechanical conversion scale, hopper scale and other electronic weighing devices.



Features:

Capacity : 1 kg to 500 kg

Defend grade: IP66

High accuracy.

Alloy steel or stainless steel.

Integral installation, Low profile. reliable performance

Electrical connection and Dimensions:

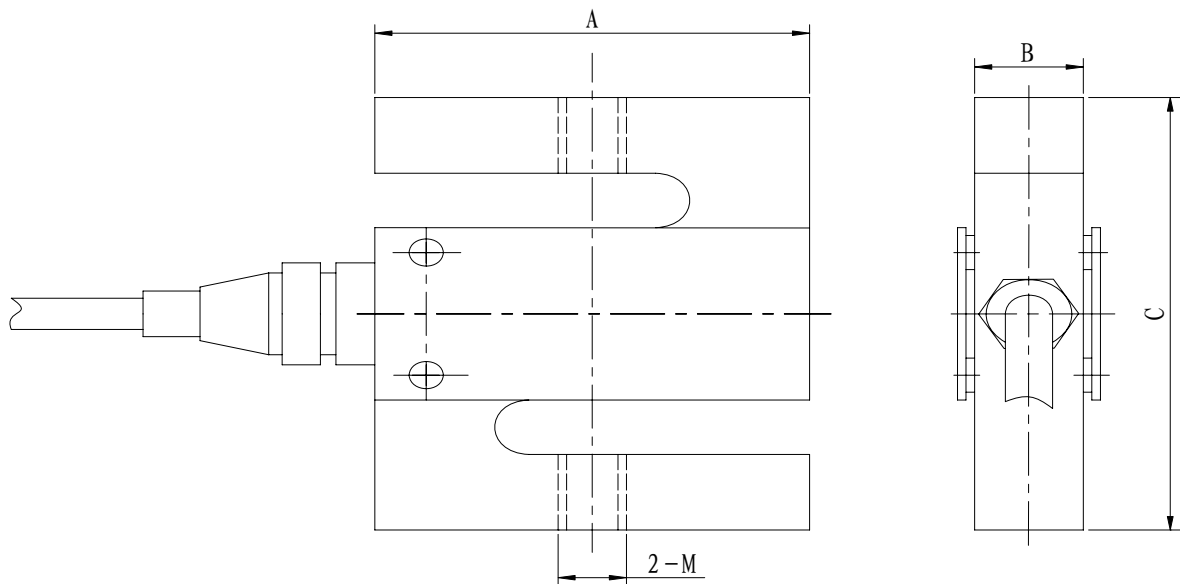

Cap (kg)	1 ~ 5	10 ~ 50	100	150 ~ 500
A (mm)	70	50.8	50.8	64
B (mm)	10	12.7	19.1	23
C (mm)	60	63.5	76.2	82
M (mm)	M6	M8	M12	M 12*1.75

Technical Specifications

Specifications:			
Capacity	Kg	1~500	
Safe overload	%FS	120	
Ultimate overload	%FS	150	
Rated output	mV/V	2.0 ± 0.004	
Excitation voltage	Vdc	9 ~ 12	
Combined error	%FS	± 0.03	± 0.02
Zero unbalance	%FS	± 1	
Non-linearity	%FS	± 0.03	± 0.02
Hysteresis	%FS	± 0.03	± 0.02
Repeatability	%FS	± 0.02	± 0.02
Creep	%FS/30min	± 0.03	± 0.02
Input resistance	Ω	350 ± 5	
Output resistance	Ω	350 ± 3	
Insulation resistance	M Ω	≥ 5000 @ 100 Vdc	
Operating temperature range	°C	-20~ +55	
Compensated temperature range	°C	-10 ~ +40	
Temperature coefficient of SPAN	%FS/10°C	± 0.02	±0.015
Temperature coefficient of ZERO	%FS/10°C	± 0.03	±0.02

Electrical connection:

Excitation+ red Excitation- black Signal+ green Signal- white

Four-core shielded cable with polyethylene.

Cable diameter : \varnothing 5mm

Cable length: 3 m

The cable length could be chose by customer's application.